

AS-9000

SPECIALTY DOORS Gasketed Access Door

Application

- Designed to provide a gasketed fit in all types of walls and ceilings
- This door is commonly used in clean rooms, laboratories, operating rooms, etc.

Product Features

- Gasketed access door
- Formed door panel with reinforced edges and a concealed hinge, along with open cell gasket between the door and frame

AS-9000 Access Door Specifications:

Door / Door Frame: Stainless Steel or Steel: 18 gauge door, 18 gauge mounting frame, flange to be 1" wide

Hinge: Concealed

Gasket: Pemko S88 adhesive-backed bulb silicone gasket

Standard Latch: Stainless Steel Slotted Screwdriver Cam Latch

Optional Latches/Locks: Cylinder lock & key, allen head cam latch, spanner head cam latch, torx head with security pin

Finish: Stainless steel: #4 satin polish. Steel: 5 stage iron phosphate with prime coat of White alkyd baked-on enamel

Please note the AS-9000 has not been tested for air penetration. For a door that has been tested for Air & Water penetration see ADWT model.



AS-9000 STANDARD SIZES

(other sizes available upon request)

Nominal Door Size W&H		Weight per Door	
Inches	mm	lbs.	kg.
12 X 12	305 X 305	6	2.7
16 X 16	406 X 406	10	4.5
18 X 18	457 X 457	11.5	5.1
24 X 24	610 X 610	19	8.4
24 X 36	610 X 914	28	12.4

Wall or ceiling opening is nominal door size + 3/8" (9 mm)
For detailed specifications see submittal sheet

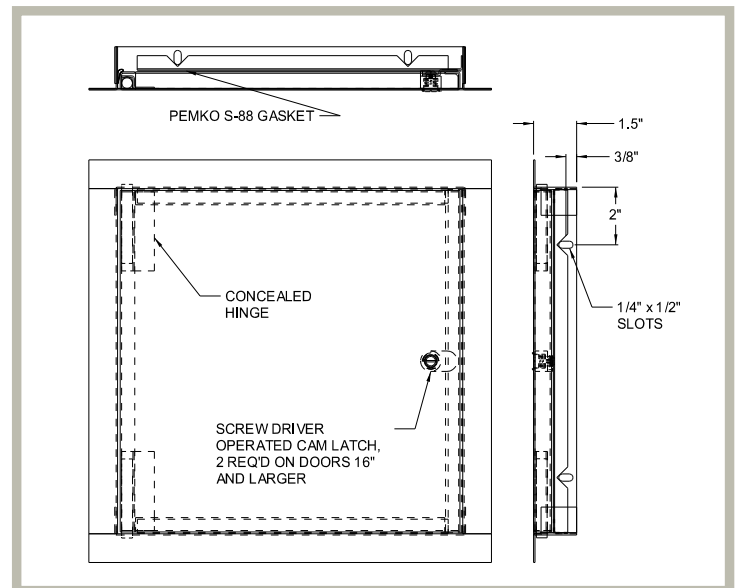

AS-9000 STANDARD SIZES

(other sizes available upon request)

Nominal Door Size W&H		Weight per Door	
Inches	mm	lbs.	kg.
12 X 12	305 X 305	6	2.7
16 X 16	406 X 406	10	4.5
18 X 18	457 X 457	11.5	5.1
24 X 24	610 X 610	19	8.4
24 X 36	610 X 914	28	12.4

Wall or ceiling opening is nominal door size + 3/8" (9 mm)

For detailed specifications see submittal sheet